

XMA

Catalog
2022



www.xma.mx

At XMA Masking Solutions we provide professional masking solutions for industrial coating processes, whether it is spray painting, electrostatic painting, plating, or, in general, for all those surface coating processes where it is required to protect some area or component.



We are a company located in the US/Mexico border, dedicated to manufacturing adhesive and masking tapes for medium/high temperature, as well as distributing reusable silicone caps and plugs for our clients in across Mexico and southern United States.



As part of our commitment to service, we have an inventory of the most common parts, and additionally we count with slitting capabilities (cut-to-size) as well as die-cutting and a cutting plotter for custom masking and quick order turnaround.

This allows us to provide quality products for high/medium/ low volumes with a fast response time.



INDEX

HIGH TEMPERATURE TAPE	4
POLYESTER (PET) GREEN TAPE.....	4
POLYESTER PET TAPE	4
POLYIMIDE TAPE.....	5
MASKING TAPE.....	5
DOTS	5
POLYIMIDE DOTS	6
PRECISION CUT CUSTOM MASKING	6
PLUGS & CAPS	7
TMF.....	7
AFR.....	7
DFPP	8
CSINK	8
CPP.....	9
EPP.....	10
EP	11
BP.....	12
CHPS	13
ETM.....	13
MHEP	14
WFP	14
HEP	15
FP.....	16
SP	17
EC.....	17
EE.....	20
EQ	21
FC.....	22
SZC.....	23
CCC.....	24
CBI.....	24
CF.....	25
CR.....	25
ACCESSORIES.....	26
HOOKS	26

HIGH TEMPERATURE TAPE

Polyester (PET) Green tape

Powder coating and anodizing applications.

Clean removal, no adhesive residue. Polyester base layer (PET), Silicone adhesive.

Cut-to-size rolls from 5mm to 940 mm



	High Temperature Polyester Tape (PET)	High Temperature Polyester Tape (PET)	High Temperature Polyester Tape (PET)
	EPL	EPM	EPT
Side	Single	Single	Single
Temperature (max) oC	204	204	204
Color	Green	Green	Green
Base Layer film	Polyester (PET)	Polyester (PET)	Polyester (PET)
Base Layer Thickness	0.03 mm	0.04 mm	0.05 mm
Adhesive Layer	Silicone	Silicone	Silicone
Adhesive Thickness	0.02 mm	0.03 mm	0.04 mm
Total Thickness	0.05 mm	0.07 mm	0.09 mm
Roll Length	66	66	66

Polyester PET tape

Powder coating and anodizing applications.

Clean removal, no adhesive residue. Polyester base layer (PET), Silicone adhesive.

Cut-to-size rolls from 5mm to 940 mm

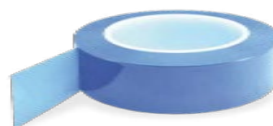

	High Temperature Polyester Tape (PET)	High Temperature Polyester Tape (PET)	High Temperature Polyester Tape (PET)
	EPR	EPB	CLT
Side	Single	Single	Single
Temperature (max) oC	220	204	204
Color	Red	Blue	Clear
Base Layer film	Polyester (PET)	Polyester (PET)	Polyester (PET)
Base Layer Thickness	0.025 mm	0.05 mm	0.05 mm
Adhesive Layer	Silicone	Silicone	Silicone
Adhesive Thickness	0.07 mm	0.05 mm	0.04 mm
Roll Length	66	66	66

Polyimide tape

Recommended for powder coating and E-coating. Clean removal, no adhesive residue. Excellent chemical resistance. 0,025 mm polyimide, 0,04 mm silicone adhesive.

High Temperature Polyimide Tape

	PC
Side	Single
Temperature (max) oC	260
Color	Amber
Base Layer film	Polymide
Base Layer Thickness	0.025 mm
Adhesive Layer	Silicone
Adhesive Thickness	0.04 mm
Roll Length	33

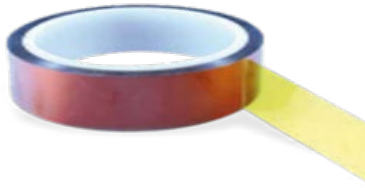

Masking Tape

Recommended for painting. Clean removal.



High Temperature Masking tape

	EPG
Side	Single
Temperature (max) oC	140
Color	White/red
Base Layer film	Crepe Paper
Thickness	0.2 mm
Roll Length	50

DOTS

Powder coating and anodizing applications.

Clean removal, no adhesive residue. Polyester base layer (PET), Silicone adhesive. Cut-to-size from 3 mm to 500 mm, rolls with 100 to 2,000 pcs.

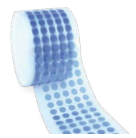
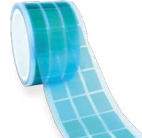
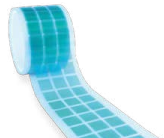
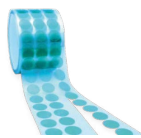

	High Temperature Tape EPC	High Temperature Tape QPL	High Temperature Tape EPB	High Temperature Tape CLD	High Temperature Tape EBC
Shape	Circle	Square	Rectangle	Circle	Circle
Temperature (max) oC	204	204	204	204	204
Color	Green	Green	Green	Clear	Blue
Base Layer film	Polyester (PET)	Polyester (PET)	Polyester (PET)	Polyester (PET)	Polyester (PET)
Base Layer Thickness	0.05 mm	0.05 mm	0.05 mm	0.025 mm	0.05 mm
Adhesive Layer	Silicone	Silicone	Silicone	Silicone	Silicone
Adhesive Thickness	0.04 mm	0.04 mm	0.04 mm	0.04 mm	0.05 mm
Pcs/roll	2000	2000	2000	2000	2000

Polyimide DOTS

Powder coating and anodizing applications. Clean removal, no adhesive residue.

High Temperature Tape	
BPC	
Shape	Circle
Temperature (max) oC	260
Color	Amber
Base Layer film	Polyimide
Base Layer Thickness	0.025 mm
Adhesive Layer	Silicone
Adhesive Thickness	0.04 mm
Pcs/roll	2000



Precision cut custom masking

Powder coating and anodizing applications. Clean removal, no adhesive residue.

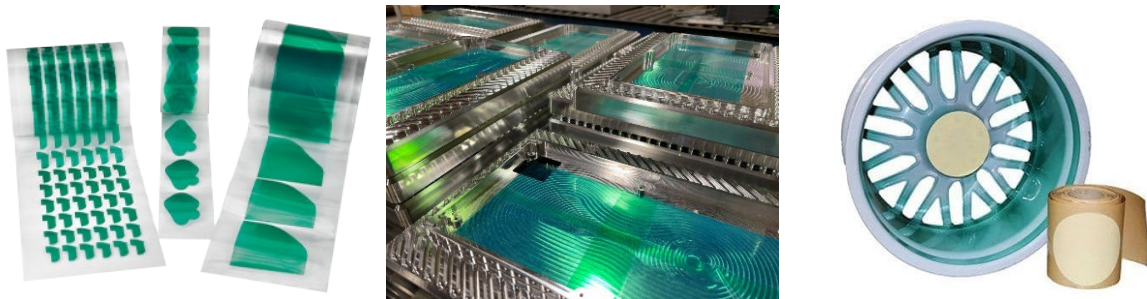

Die Cut available for production of large volumes.
Plotter technology for smaller volumes
Quick preparation and low fabrication costs



PLUGS & CAPS

TMF

Rings, tube fragments and washers. Silicone and EPDM made.

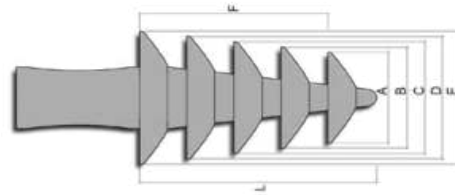

CODE	A	B	C	D	E	F	L	PCS. BOX
TMF4-10	4,00	6,00	8,00	10,00	-	10,63	13,60	500
TMF8-16	8,00	10,00	12,00	14,00	16,00	19,00	23,50	200
TMF10-18	10,00	12,00	14,00	16,00	18,00	19,00	24,00	200

AFR

Rings, tube fragments and washers. Silicone and EPDM made.

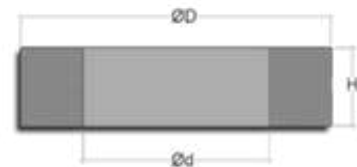

CODE	ØD (mm)	Ød (mm)	H (mm)	PCS. BOX
AFR8X3	8,00	3,00	1,50	100
AFR9X86	9,53	6,35	31,75	100
AFR13X8	13,00	8,00	2,00	100
AFR14X4	14,27	4,75	25,40	100
AFR16X9	16,00	9,50	2,00	100
AFR16X8	16,50	8,00	2,00	100
AFR21X8	21,20	8,00	10,00	10
AFR24X9	24,00	9,00	25,00	10
AFR24X12	24,00	12,00	3,00	10
AFR30X9	30,00	9,00	25,00	10
AFR32X26	32,00	26,00	160,00	10
AFR36X25	36,00	25,00	50,00	10
AFR39X32	39,00	32,00	2,00	10
AFR42X36	42,00	36,00	160,00	10
AFR47X41	47,00	41,00	160,00	10
AFR50X30	50,00	30,00	5,00	1
AFR52X46	52,00	46,00	160,00	1
AFR60X40	60,00	40,00	5,00	1
AFR60X50	60,20	50,00	80,00	1
AFR62X56	62,00	56,00	160,00	1
AFR65X32	65,00	32,00	2,00	1
AFR72X66	72,00	66,00	110,00	1
AFR78X12	78,80	12,50	10,00	1
AFR90X80	90,00	80,00	50,00	1
AFR100X85	100,00	85,00	20,00	1
AFR117X111	117,00	111,00	160,00	1
AFR164X146	164,00	146,00	5,00	1

DFPP

Special nut protection plug 315 °C

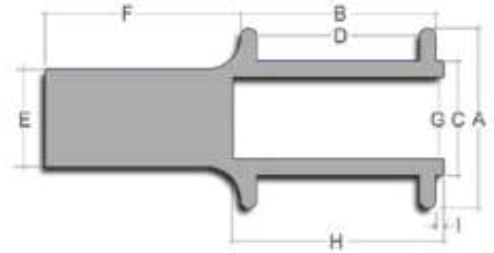

CODE	(mm)									PCS. BOX
	A	B	C	D	E	F	G	H	I	
DFPP05	5,40	5,50	4,10	3,00	3,50	15,34	1,02	6,28	1,57	500
DFPP06	6,70	7,10	5,10	3,80	4,50	20,42	1,85	9,13	2,03	500
DFPP08	8,70	7,80	6,70	5,35	5,59	20,52	3,28	9,83	2,03	500
DFPP10	11,20	9,50	8,50	6,60	5,50	20,42	5,08	10,33	2,03	500
DFPP12	13,00	10,10	10,10	6,60	5,61	27,81	5,08	12,13	2,03	250
DFPP14	15,20	11,50	12,10	8,00	8,00	29,00	6,50	12,53	2,03	250
DFPP16	16,60	13,50	13,90	9,30	10,15	32,00	7,70	15,53	2,03	100
DFPP18	19,80	14,50	15,90	10,50	10,15	32,00	10,30	16,53	2,03	100
DFPP20	21,01	15,30	17,80	12,30	12,30	33,80	10,25	17,33	2,03	100

CSINK

Countersink Plugs 315 °C. Recommended for powder coating, E-coating, and plating

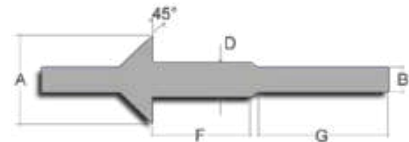

CODE	(mm)					PCS. BOX
	A	B	D	F	G	
CSINK030	10,00	2,50	2,90	15,00	20,00	100
CSINK040	10,00	3,00	3,80	15,00	20,00	100
CSINK045	12,00	3,00	4,50	15,00	20,00	100
CSINK050	15,00	4,00	5,00	15,00	20,00	100
CSINK060	14,00	4,00	5,50	15,00	20,00	100
CSINK080	16,00	4,00	7,40	15,00	20,00	100
CSINK100	18,00	5,00	9,20	15,00	25,00	100
CSINK120	20,00	5,00	11,00	15,00	25,00	100
CSINK140	20,00	6,00	13,46	15,00	20,00	100

CPP

Pull Plug 315 °C, Recommended for powder coating, E-coating, anodizing, and plating. Ideal for through holes.

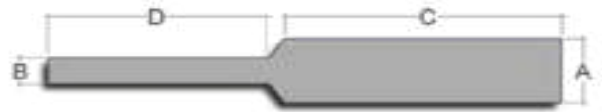

CODE	COLOR	HOLES	(mm)				PCS. BOX
			A	B	C	D	
CPP06	blue		1,57	1,02	12,70	12,70	500
CPP07	white		1,70	1,19	15,88	15,49	500
CPP08	green		1,85	1,17	15,54	14,99	500
CPP09	red		2,31	1,32	15,88	15,88	500
CPP10(2)	pink		2,36	1,27	15,88	15,88	500
CPP95-1000	grey		2,41	1,32	25,40	25,40	500
CPP10(A)	light blue		2,67	2,08	25,40	25,40	500
CPP11	light green		2,77	1,57	25,40	25,40	500
CPP11B	yellow		3,00	2,08	25,40	25,40	500
CPP11A(3)	purple	3F	3,18	1,57	15,88	15,88	500
CPP15	blue	3L / 3F	3,30	2,36	15,88	17,78	500
CPP14	white	3L / 3F	3,30	2,36	25,40	25,40	500
CPP17	green	3L	3,56	2,16	15,88	14,17	500
CPP18	red		3,91	1,57	15,88	15,88	500
CPP20(4A)	pink	4F	3,96	1,57	15,88	19,05	500
CPP21	grey	4F	4,01	2,08	31,75	31,75	500
CPP22	light blue	4L / 4F	4,11	2,44	15,88	14,76	500
CPP23(4)	light green	5F	4,95	2,79	25,40	25,40	500
CPP26	purple	5F	5,00	2,79	25,40	25,40	500
CPP30	yellow	5L / 6F	5,54	3,30	25,40	25,40	500
CPP33	clear	5L / 6F	5,72	3,18	25,40	25,40	500
CPP37(5)	blue	6L	6,53	3,30	25,40	25,40	500
CPP40	white	6L / 8F	6,99	3,18	23,80	23,37	500
CPP42(6)	green	8F	7,92	3,73	25,40	25,40	500
CPP42	red	8L	8,43	6,35	28,58	20,29	500
CPP43	pink	8L	8,51	3,89	25,40	25,40	500
CPP355-1000	blue		9,02	3,99	25,40	25,40	500
CPP50	grey	10F	9,53	3,99	25,40	25,40	500
CPP55	light blue	10F	9,75	3,91	25,40	25,40	250
CPP55(7)	light green	10F	9,86	3,99	25,40	25,40	250
CPP60	yellow	10L / 12F	10,36	4,85	25,63	25,40	250
CPP63	purple	12F	10,52	3,99	13,34	19,18	250
CPP66	blue	12F	11,28	6,48	25,40	25,15	250
CPP67	white	12F	11,30	6,48	25,40	25,40	250
CPP70	white		11,89	6,35	25,40	25,40	250
CPP73	red	12L / 14F	12,60	6,35	25,40	25,40	250
CPP77	pink		12,95	6,50	25,40	24,28	250
CPP80	grey		13,46	6,35	25,40	25,40	250
CPP570-1000	light blue		14,48	7,92	25,40	25,40	100
CPP87	light green		15,54	6,35	25,40	25,40	100
CPP88	yellow		15,75	8,36	38,10	38,10	100
CPP90	purple		16,26	9,53	25,40	25,40	100
CPP95	green	16L	17,78	9,53	31,75	31,75	100
CPP100	blue		19,56	9,53	25,40	23,55	100
CPP809-1000	pink		20,55	8,00	25,40	25,40	50
CPP110(13)	white		22,76	9,53	25,40	25,40	50
CPP120	green		25,91	9,53	25,40	24,64	50
CPP130	red		35,05	12,70	25,40	25,40	50

EPP

E.P.D.M. Pull Plug 177 °C (EPP), Recommended for painting, plating, anodizing, and blasting. Ideal for through holes.

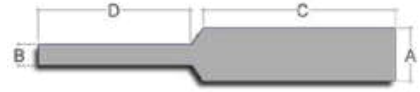

CODE	HOLES (L=smooth, F= Threaded)	(mm)				PCS. BOX
		A	B	C	D	
EPP06		1,57	1,02	12,70	12,70	500
EPP07		1,70	1,19	15,88	15,49	500
EPP08(1)		1,85	1,17	15,54	14,99	500
EPP09		2,31	1,32	15,88	15,88	500
EPP10(2)		2,36	1,27	15,88	15,88	500
EPP10A		2,67	2,08	25,40	25,40	500
EPP11		2,77	1,57	25,40	25,40	500
EPP11B		3,00	2,08	25,40	25,40	500
EPP11A(3)	3F	3,18	1,57	15,88	15,88	500
EPP15	3L / 3F	3,30	2,36	15,88	17,78	500
EPP14	3L / 3F	3,30	2,36	25,40	25,40	500
EPP17	3L	3,56	2,16	15,88	14,17	500
EPP18		3,91	1,57	15,88	15,88	500
EPP20(4A)	4F	3,96	1,57	15,88	19,05	500
EPP21	4F	4,01	2,08	31,75	31,75	500
EPP22	4L / 4F	4,11	2,44	15,88	14,76	500
EPP23(4)	5F	4,95	2,79	25,40	25,40	500
EPP26	5F	5,00	2,79	25,40	25,40	500
EPP30	5L / 6F	5,54	3,30	25,40	25,40	500
EPP33	5L / 6F	5,72	3,18	25,40	25,40	500
EPP37(5)	6L	6,53	3,30	25,40	25,40	500
EPP40	6L / 8F	6,99	3,18	23,80	23,37	500
EPP42(6)	8F	7,92	3,73	25,40	25,40	500
EPP42A	8L	8,43	6,35	28,58	20,29	500
EPP43	8L	8,51	3,89	25,40	25,40	500
EPP50		9,53	3,99	25,40	25,40	500
EPP55(7)	10F	9,86	3,99	25,40	25,40	250
EPP400-1000		10,16	3,99	25,40	25,40	250
EPP60	10L / 12F	10,36	4,85	25,63	25,40	250
EPP63		10,52	3,99	13,34	19,18	250
EPP66(8)	12F	11,28	6,48	25,40	25,15	250
EPP67(8)	12F	11,30	6,48	25,40	25,40	250
EPP70		11,89	6,35	25,40	25,40	250
EPP73(9)	12L / 14F	12,60	6,35	25,40	25,40	250
EPP77		12,95	6,50	25,40	24,28	250
EPP80(10)		13,46	6,35	25,40	25,40	250
EPP87		15,54	6,35	25,40	25,40	100
EPP88		15,75	8,36	38,10	38,10	100
EPP90(11)		16,26	9,53	25,40	25,40	100
EPP95	16L	17,78	9,53	31,75	31,75	100
EPP100(12)		19,56	9,53	25,40	23,55	100
EPP110(13)		22,76	9,53	25,40	25,40	50
EPP120(14)		25,91	9,53	25,40	24,64	50
EPP130		35,05	12,70	25,40	25,40	50

EP

Plugs 315 °C. Recommended for powder coating, E-coating and plating. Reusable.

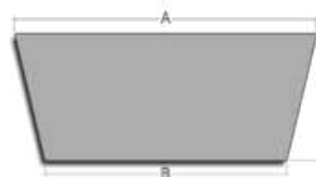

CODE	COLOR	(mm)			PCS. BOX
		A	B	L	
EP63	light blue	1,60	0,41	15,88	1000
EP78	yellow	1,98	0,51	19,05	1000
EP81	clear	2,54	0,81	15,88	1000
EP99	white	3,18	0,79	15,88	1000
EP100	green	3,18	1,60	15,88	1000
EP101SH	purple	4,75	2,79	10,01	1000
EP101	pink	4,75	1,60	15,88	1000
EP101XL	light blue	4,75	1,60	19,05	1000
EP101SXL	yellow	4,75	1,60	25,40	1000
EP102	grey	6,35	3,18	19,05	1000
EP102XL	light green	6,35	3,18	25,40	1000
EP103	red	8,71	4,78	15,88	1000
EP103XL	pink	8,71	4,78	25,40	1000
EP105	green	9,53	6,35	12,70	100
EP104	yellow	9,53	6,35	19,05	100
EP375XL	light blue	9,53	3,18	31,75	100
EP394XL	light green	10,01	5,00	48,01	100
EP104XL	grey	11,10	6,35	25,40	100
EP106	red	11,13	8,74	17,48	100
EP000	white	11,91	8,74	20,65	100
EP000XL	green	12,70	7,90	25,40	100
EP500XL	pink	12,70	3,20	50,80	100
EP107	light blue	14,30	7,95	25,40	100
EP107XL	clear	15,01	3,00	35,00	100
EP00	grey	15,09	10,31	25,40	100
EP108	light green	15,88	11,13	22,23	100
EP0	red	16,66	12,70	25,40	100
EP109	clear	17,45	11,13	25,40	100
EP1	yellow	19,00	14,27	25,40	100
EP2	white	19,99	15,88	25,40	100
EP2,5	green	20,62	15,88	25,40	100
EP3	pink	23,83	18,26	25,40	100
EP3,5	clear	25,00	17,00	25,40	100
EP4	light blue	25,40	19,84	25,40	100
EP4,5	grey	26,01	19,99	25,40	100
EP5	light green	27,00	23,01	25,40	100
EP5,5	red	27,94	23,83	25,40	100
EP6	yellow	31,75	26,19	25,40	100
EP6,5	white	33,35	27,00	25,40	100
EP7	green	36,53	30,18	25,40	10
EP7,5	pink	38,89	31,75	25,40	10
EP8	light blue	41,28	33,35	25,40	10
EP8,5	grey	42,88	35,71	25,40	10
EP9	light green	44,45	37,31	25,40	10
EP9,5	red	46,05	38,10	25,40	10
EP10	yellow	50,01	41,28	25,40	10
EP10,5	white	52,40	44,45	25,40	10
EP11	green	55,96	47,63	25,40	1
EP11,5	pink	62,71	50,01	25,40	1
EP12	light blue	63,50	53,98	25,40	1
EP13	grey	68,28	57,94	25,40	1
EP13,5	light green	75,01	61,93	34,93	1
EP13,78	clear	82,00	68,00	35,00	1
EP14	red	88,90	76,20	38,10	1
EP15	yellow	101,60	82,55	38,10	1
EP16	white	127,00	88,90	50,80	1

BP

Black E.P.D.M. Plugs 177 °C. Recommended for painting, plating, anodizing, and blasting.

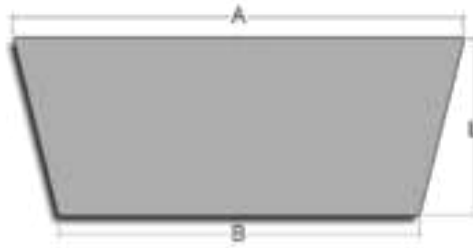

CODE	(mm)			PCS. BOX
	A	B	L	
BP63	1,60	0,41	15,88	1000
BP78	1,98	0,51	19,05	1000
BP81	2,54	0,81	15,88	1000
BP99	3,18	0,79	15,88	1000
BP100	3,18	1,60	15,88	1000
BP101SH	4,75	2,79	10,01	1000
BP101	4,75	1,60	15,88	1000
BP101XL	4,75	1,60	19,05	1000
BP101SXL	4,75	1,60	25,40	1000
BP102	6,35	3,18	19,05	1000
BP102XL	6,35	3,18	25,40	1000
BP103	8,71	4,78	15,88	1000
BP103XL	8,71	4,78	25,40	1000
BP105	9,53	6,35	12,70	100
BP104	9,53	6,35	19,05	100
BP375XL	9,53	3,18	31,75	100
BP394XL	10,01	5,00	48,01	100
BP104XL	11,10	6,35	25,40	100
BP106	11,13	8,74	17,48	100
BP000	11,91	8,74	20,65	100
BP000XL	12,70	7,90	25,40	100
BP500XL	12,70	3,20	50,80	100
BP107	14,30	7,95	25,40	100
BP107XL	15,01	3,00	35,00	100
BP00	15,09	10,31	25,40	100
BP108	15,88	11,13	22,23	100
BP0	16,66	12,70	25,40	100
BP109	17,45	11,13	25,40	100
BP1	19,00	14,27	25,40	100
BP2	19,99	15,88	25,40	100
BP2,5	20,62	15,88	25,40	100
BP3	23,83	18,26	25,40	100
BP3,5	25,00	17,00	25,40	100
BP4	25,40	19,84	25,40	100
BP4,5	26,01	19,99	25,40	100
BP5	27,00	23,01	25,40	100
BP5,5	27,94	23,83	25,40	100
BP6	31,75	26,19	25,40	100
BP6,5	33,35	27,00	25,40	100
BP7	36,53	30,18	25,40	100
BP7,5	38,89	31,75	25,40	50
BP8	41,28	33,35	25,40	50
BP8,5	42,88	35,71	25,40	50
BP9	44,45	37,31	25,40	50
BP9,5	46,05	38,10	25,40	50
BP10	50,01	41,28	25,40	50
BP10,5	52,40	44,45	25,40	50
BP11	55,96	47,63	25,40	1
BP11,5	62,71	50,01	25,40	1
BP12	63,50	53,98	25,40	1
BP13	68,28	57,94	25,40	1
BP13,5	75,01	61,93	34,93	1
BP13,78	68,00	82,00	35,00	1
BP14	88,90	76,20	38,10	1
BP15	101,60	82,55	38,10	1
BP16	127,00	88,90	50,80	1

CHPS

Silicone conical plugs with handle 315 °C. Recommended for powder coating, E-coating and plating. Reusable.

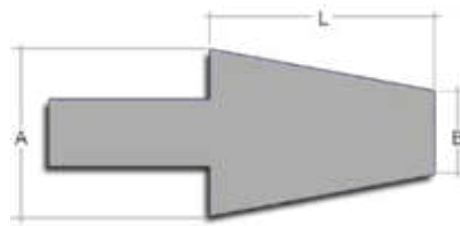

CODE	(mm)			PCS. BOX
	A	B	L	
CPHS100	3,18	1,60	15,88	1000
CPHS101	4,75	1,60	15,88	1000
CPHS102	6,35	3,18	19,05	1000
CPHS103	8,71	4,78	15,88	1000
CPHS104	9,53	6,35	19,05	100
CPHS000	11,91	8,74	20,65	100
CPHS00	15,09	10,31	25,40	100
CPHS0	16,66	12,70	25,40	100

ETM

Thread mask 315 °C

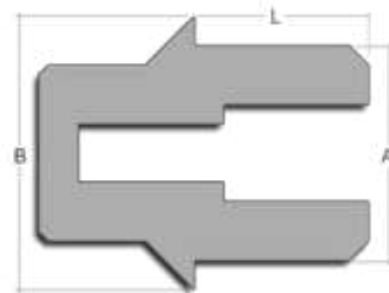

CODE	COLOR	(mm)			PCS. BOX
		A	B	L	
ETM6	green	5,33	6,35	5,08	500
ETM8	pink	7,20	8,55	3,20	500
ETM10	blue	9,00	10,15	4,70	250
ETM12	red	11,00	12,20	6,70	250
ETM16	yellow	14,90	16,60	8,30	100
ETM20	clear	18,40	20,50	10,30	100

MHEP

Hollow conical plug with handle 315 °C.

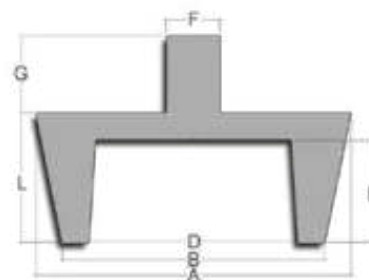
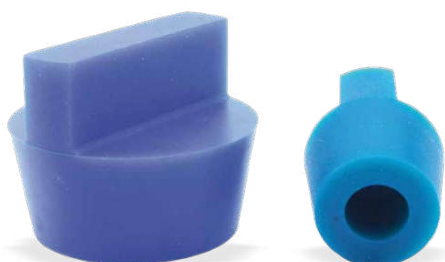

CODE	(mm)							PCS. BOX
	A	B	C	D	E	F	G	
MHEP5	27,00	23,01	25,40	10,31	19,05	10,21	19,05	100
MHEP6	31,75	26,19	25,40	13,49	19,05	12,70	19,05	100
MHEP7	36,50	30,15	25,40	17,45	19,05	12,70	19,05	10
MHEP10	50,01	41,28	25,40	28,58	19,05	12,70	19,05	10
MHEP11	55,96	47,63	25,40	34,93	19,05	12,70	19,05	1

WFP

Silicone Flange Plugs 315 °C. Ideal for masking holes and the grounding area around them. Dual purpose plugs.

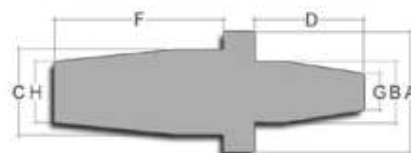

CODE	Holes	(mm)							PCS. BOX
		A	B	C	D	F	G	H	
WFP110-276-146	M3	7,00	2,80	3,70	5,80	7,40	1,40	1,90	1000
WFP142-354-195	M4	9,00	3,60	4,70	7,20	9,40	1,80	2,40	1000
WFP177-394-224	M5	9,50	4,50	5,70	9,00	11,40	2,30	2,80	1000
WFP289-492-264	M6	12,50	5,30	6,70	10,60	13,40	2,60	3,40	500
WFP280-669-343	M8	17,00	7,10	8,70	14,20	17,40	3,60	4,30	500
WFP378-827-421	M10	21,00	9,60	10,70	19,20	21,40	4,80	5,40	250
WFP429-945-500	M12	24,00	10,90	12,70	21,80	25,40	5,50	6,40	250

HEP

Hollow silicone plugs 315 °C. Recommended for powder coating, E-coating and plating. Reusable.

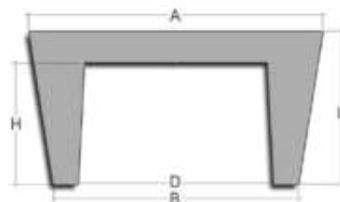

CODE	(mm)					PCS. BOX
	A	B	L	D	H	
HEP5	27,00	23,01	25,40	12,50	19,05	100
HEP5,5	27,94	24,00	25,40	13,00	19,05	100
HEP6	32,00	26,19	25,40	15,50	19,05	100
HEP6,5	33,99	27,00	25,40	17,00	19,05	100
HEP7	36,53	30,18	25,40	17,48	19,05	10
HEP7,5	38,99	30,99	25,40	21,80	19,05	10
HEP8	41,28	33,35	25,40	20,65	19,05	10
HEP8,5	43,00	35,99	25,40	26,00	19,05	10
HEP9	44,45	37,31	25,40	24,61	19,05	10
HEP9,5	45,97	38,00	25,40	25,30	19,05	10
HEP10	49,99	41,99	25,40	31,60	19,05	10
HEP10,5	52,98	44,96	25,40	32,26	19,05	10
HEP11	55,96	48,01	25,40	35,31	19,05	1
HEP11,5	62,71	50,01	25,40	30,96	15,88	1
HEP12	63,50	53,98	25,40	34,93	15,88	1
HEP13	68,28	57,94	25,40	38,89	15,88	1
HEP13,5	75,01	61,93	34,93	42,88	25,40	1
HEP13,78	81,99	68,00	38,10	42,60	25,40	1
HEP14	88,90	76,20	38,10	50,80	25,40	1
HEP15	101,60	82,55	38,10	57,15	25,40	1
HEP16	127,00	88,90	50,80	78,00	30,00	1

FP

Flangeless Plugs 315 °C. Recommended for powder coating, E-coating, plating and anodizing. Threaded holes. Tapered design and hollow core for multi-applications. Protect threaded holes without masking the surrounding area.

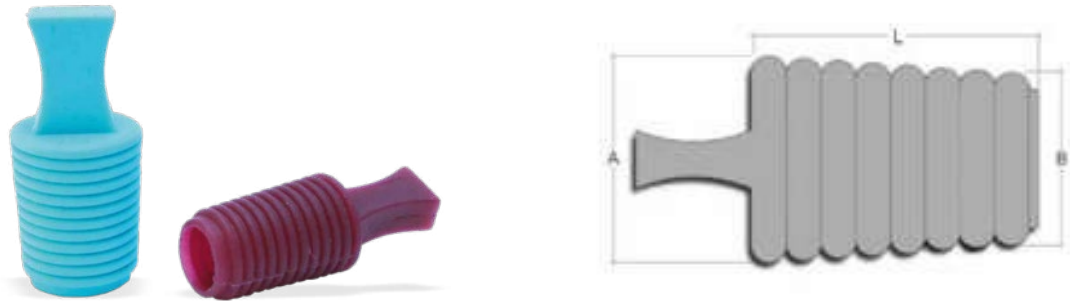

CODE	(mm)			PCS. BOX
	A	B	L	
FP157	3,99	2,01	19,05	250
FP250	5,99	3,99	25,40	250
FP312	8,00	5,99	25,40	250
FP394	10,01	8,00	25,40	250
FP406	10,31	7,95	25,40	250
FP468	11,89	10,31	25,40	250
FP472	11,99	10,01	25,40	250
FP551	14,00	11,99	25,40	250
FP562	14,27	11,89	25,40	250
FP625	15,88	14,27	25,40	250
FP630	16,00	14,00	25,40	250
FP709	18,01	16,00	25,40	250
FP718	18,24	15,88	25,40	250
FP750	19,05	18,24	25,40	100
FP787	19,99	18,01	25,40	100
FP866	22,23	19,05	25,40	100
FP886	22,50	19,99	25,40	100
FP945	24,00	22,50	25,40	100
FP1000	25,40	22,23	25,40	100
FP1024	26,01	24,00	25,40	100
FP1102	27,99	26,01	25,40	100
FP1125	28,58	25,40	25,40	100
FP1250	31,75	28,58	25,40	100

SP

Step Plugs 315 °C. Recommended for powder coating, E-coating, anodizing and plating. Provides clean area around diameter of hole for earthing purpose.

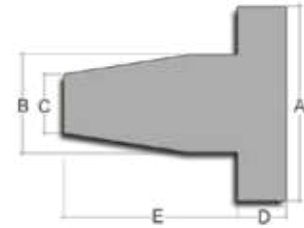

CODE	(mm)					PCS. BOX
	A	B	C	D	E	
SP03	7,01	3,00	2,36	7,01	13,00	500
SP04	8,00	5,00	2,84	8,00	14,00	500
SP05	8,99	5,99	3,94	8,99	16,03	500
SP06	10,16	6,43	4,78	10,16	17,63	250
SP08	12,42	8,23	5,94	9,75	17,32	250

EC

Powder Coating Caps 315 °C.

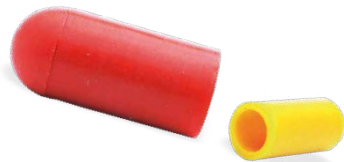

CODE	COLOR	THREAD	(mm)			PCS. BOX
			A	C	L	
EC20	clear		0,51	3,55	12,70	1000
EC35	purple		0,89	3,43	12,70	1000
EC40-500	clear		1,02	3,32	12,70	1000
EC40-750	clear		1,02	3,30	19,05	1000
EC62-750	orange		1,57	3,80	19,05	1000
EC70	rusty red	M2	1,78	4,08	25,40	1000
EC80-750	grey		2,03	5,07	19,05	1000
EC93-500	white		2,36	4,95	12,70	1000
EC93-750	white		2,36	4,95	19,05	1000
EC100-500	green	M3	2,54	5,13	12,70	1000
EC100-750	green	M3	2,54	5,13	19,05	1000
EC100	green	M3	2,54	5,13	25,40	1000
EC100-1500	green	M3	2,54	5,58	38,10	1000

CODE	COLOR	THREAD	(mm)			PCS. BOX
			A	C	L	
EC109-500	red		2,77	5,81	12,70	1000
EC109	red		2,77	5,36	19,05	1000
EC125-500	blue		3,18	5,77	12,70	1000
EC125-750	blue		3,18	6,22	19,05	1000
EC125	blue		3,18	5,77	25,40	1000
EC125-1500	blue		3,18	6,22	38,10	1000
EC137-1000	green		3,48	6,52	25,40	1000
EC140-500	white		3,56	6,60	12,70	1000
EC140	white		3,56	6,60	25,40	1000
EC148-500	grey	M4	3,76	6,80	12,70	1000
EC148-750	grey	M4	3,76	6,80	19,05	1000
EC148	grey	M4	3,76	6,80	25,40	1000
EC148-1500	grey	M4	3,76	6,80	38,10	1000
EC156-500	yellow		3,96	7,00	12,70	1000
EC156	yellow		3,96	7,00	25,40	1000
EC165-1000	clear		4,19	7,23	25,40	1000
EC172-500	blue		4,37	7,41	12,70	1000
EC172	blue		4,37	7,41	25,40	1000
EC172-1500	blue		4,37	7,41	38,10	1000
EC180	grey		4,57	7,61	25,40	1000
EC187-500	red	M5	4,75	7,79	12,70	1000
EC187-750	red	M5	4,75	7,79	19,05	1000
EC187	red	M5	4,75	7,79	25,40	1000
EC187-1500	red	M5	4,75	7,79	38,10	1000
EC197-500	clear		5,00	8,04	12,70	500
EC218	light blue		5,54	8,58	25,40	500
EC223-500	pink	M6	5,66	8,70	12,70	500
EC223-750	pink	M6	5,66	8,70	19,05	500
EC223-1000	pink	M6	5,66	8,70	25,40	500
EC223	pink	M6	5,66	8,70	38,10	500
EC234-500	green		5,94	8,98	12,70	500
EC234-750	green		5,94	8,98	20,00	500
EC234	green		5,94	8,98	25,40	500
EC234-1500	green		5,94	8,98	38,10	500
EC250-500	grey		6,35	9,39	12,70	500
EC250	grey		6,35	9,39	25,40	500
EC260	red		6,60	9,64	25,40	500
EC281	light green		7,14	10,18	25,40	500
EC281-2000	light green		7,14	10,18	50,80	500
EC295-500	light blue	M8	7,49	10,53	12,70	500
EC295-750	light blue	M8	7,49	10,53	19,05	500
EC295-1000	light blue	M8	7,49	10,53	25,40	500
EC295	light blue	M8	7,49	10,53	38,10	500
EC295-2350	light blue	M8	7,49	10,53	59,00	500
EC312	white		7,92	10,96	25,40	500
EC312-1500	white		7,92	10,96	38,10	500
EC340	grey		8,64	11,68	25,40	500
EC355	purple		9,02	12,06	38,10	500
EC375-750	yellow	M10	9,53	12,57	19,05	500
EC375	yellow	M10	9,53	12,57	25,40	500
EC375-1500	yellow	M10	9,53	12,57	38,10	500
EC375-1969	yellow	M10	9,53	12,57	50,01	500
EC406	red		10,31	13,35	25,40	500
EC406-1500	red		10,31	13,35	38,10	500
EC437	green		11,10	14,14	25,40	500

CODE	COLOR	THREAD	(mm)			PCS. BOX
			A	C	L	
EC437-2000	green		11,10	14,14	50,80	500
EC456-500	pink	M12	11,58	14,62	12,70	500
EC456-750	pink	M12	11,58	14,62	19,05	500
EC456-1000	pink	M12	11,58	14,62	25,40	500
EC456	pink	M12	11,58	14,62	38,10	500
EC456-1969	pink	M12	11,58	14,62	50,01	500
EC468	orange		11,89	14,93	25,40	500
EC468-1500	orange		11,89	14,93	38,10	500
EC480-1000	grey		12,19	15,23	25,40	500
EC480	grey		12,19	15,23	38,10	500
EC500-750	light blue		12,70	15,74	19,05	500
EC500	light blue		12,70	15,74	38,10	500
EC535-750	yellow		13,59	16,63	19,05	250
EC535	yellow		13,59	16,63	38,10	250
EC535-3000	yellow		13,59	16,63	76,20	250
EC562-659	blue		14,27	17,31	16,74	250
EC562	blue		14,27	17,31	38,10	250
EC600	clear	M16	15,24	18,28	38,10	250
EC625-750	red		15,88	18,92	19,05	250
EC625-1125	red		15,88	18,92	28,58	250
EC625-1250	red		15,88	18,92	31,75	250
EC625	red		15,88	18,92	38,10	250
EC625-2500	red		15,88	18,92	63,50	250
EC687	green		17,45	20,49	38,10	250
EC687-2500	green		17,45	20,49	63,50	250
EC730	purple		18,54	21,58	38,10	250
EC750	orange		19,05	22,09	38,10	250
EC750-2000	orange		19,05	22,09	50,80	250
EC750-3500	orange		19,05	22,09	88,90	250
EC780	clear		19,81	22,85	38,10	250
EC812	clear		20,62	23,66	38,10	250
EC845-2844	clear		21,46	24,50	72,24	250
EC875-1000	clear		22,23	25,27	25,40	250
EC875	clear		22,23	25,27	38,10	250
EC937	clear		23,80	26,84	38,10	250
EC970	clear		24,64	27,68	38,10	250
EC1000	clear		25,40	28,44	38,10	250
EC1000-2000	clear		25,40	28,44	50,80	250
EC1062	clear		26,97	30,01	38,10	100
EC1062-2000	clear		26,97	30,01	50,80	100
EC1125	clear		28,58	31,62	38,10	100
EC1187	clear		30,15	33,19	38,10	100
EC1250	clear		31,75	34,79	38,10	100
EC1350	clear		34,29	37,33	38,10	100
EC1380	clear		35,05	38,09	38,10	100
EC1500	clear		38,10	41,14	25,40	100
EC1500-1500	clear		38,10	41,14	38,10	100
EC1500-1750	clear		38,10	41,14	44,45	50
EC1625	clear		41,28	44,32	50,80	50
EC1750	clear		44,45	47,49	50,80	50
EC1875	clear		47,63	50,67	50,80	50
EC2000	clear		50,80	53,84	50,80	50
EC2105	clear		53,47	56,51	50,80	50

EE

E.P.D.M. Caps 177 °C. Recommended for painting, plating and anodizing. Reusable.



CODE	THREAD	(mm)			PCS. BOX
		A	C	L	
EE20-500		0,51	3,55	12,70	1000
EE35-500		0,89	3,43	12,70	1000
EE40-500		1,02	3,32	12,70	1000
EE40-750		1,02	3,30	19,05	1000
EE62-750		1,57	4,61	19,05	1000
EE70-1000	M2	1,78	4,08	25,40	1000
EE80-750		2,03	5,07	19,05	1000
EE93-500		2,36	4,95	12,70	1000
EE93-750		2,36	4,95	19,05	1000
EE93-1000	M3	2,36	5,40	25,40	1000
EE100-500	M3	2,54	5,13	12,70	1000
EE100-1000	M3	2,54	5,13	25,40	1000
EE100-1500	M3	2,54	5,58	38,10	1000
EE109-500		2,77	5,81	12,70	1000
EE109-750		2,77	5,36	19,05	1000
EE125-500		3,18	5,77	12,70	1000
EE125-750		3,18	6,22	19,05	1000
EE125-1000		3,18	5,77	25,40	1000
EE125-1500		3,18	6,22	38,10	1000
EE137-1000		3,48	6,52	25,40	1000
EE140-500		3,56	6,60	12,70	1000
EE140-1000		3,56	6,60	25,40	1000
EE148-500	M4	3,76	6,80	12,70	1000
EE148-750	M4	3,76	6,80	19,05	1000
EE148-1000	M4	3,76	6,80	25,40	1000
EE148-1500	M4	3,76	6,80	38,10	1000
EE156-500		3,96	7,00	12,70	1000
EE156-1000		3,96	7,00	25,40	1000
EE165-1000		4,19	7,23	25,40	1000
EE172-500		4,37	7,41	12,70	1000
EE172-1000		4,37	7,41	25,40	1000
EE172-1500		4,37	7,41	38,10	1000
EE180-1000		4,57	7,61	25,40	1000
EE187-500	M5	4,75	7,79	12,70	1000
EE187-750	M5	4,75	7,79	19,05	1000
EE187-1000	M5	4,75	7,79	25,40	1000
EE187-1500	M5	4,75	7,79	38,10	1000
EE197-500		5,00	8,04	12,70	500

CODE	THREAD	(mm)			PCS. BOX
		A	C	L	
EE218-1000		5,54	8,58	25,40	500
EE223-500	M6	5,66	8,70	12,70	500
EE223-750	M6	5,66	8,70	19,05	500
EE223-1000	M6	5,66	8,70	25,40	500
EE223-1500	M6	5,66	8,70	38,10	500
EE234-500		5,94	8,98	12,70	500
EE234-787		5,94	8,98	19,99	500
EE234-1000		5,94	8,98	25,40	500
EE234-1500		5,94	8,98	38,10	500
EE250-500		6,35	9,39	12,70	500
EE250-1000		6,35	9,39	25,40	500
EE260-1000		6,60	9,64	25,40	500
EE281-1000		7,14	10,18	25,40	500
EE281-2000		7,14	10,18	50,80	500
EE295-500	M8	7,49	10,53	12,70	500
EE295-750	M8	7,49	10,53	19,05	500
EE295-1000	M8	7,49	10,53	25,40	500
EE295-1500	M8	7,49	10,53	38,10	500
EE295-2350	M8	7,49	10,53	60,00	500
EE312-1000		7,92	10,96	25,40	500
EE312-1500		7,92	10,96	38,10	500
EE340-1000		8,64	11,68	25,40	500
EE355-1500		9,02	12,06	38,10	500
EE375-750	M10	9,53	12,57	19,05	500
EE375-1000	M10	9,53	12,57	25,40	500
EE375-1500	M10	9,53	12,57	38,10	500
EE375-1969	M10	9,53	12,57	50,01	500
EE406-1000		10,31	13,35	25,40	500
EE406-1500		10,31	13,35	38,10	500
EE437-1000		11,10	14,14	25,40	500
EE437-2000		11,10	14,14	50,80	500

EQ

Square silicone caps 315 °C.

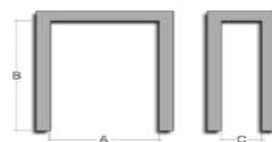

CODE	(mm)			PCS. BOX
	A	B	C	
EQ157	3,99	19,99	0,61	1000
EQ232	5,89	11,00	0,79	1000
EQ250	6,35	10,92	0,79	1000
EQ460	11,68	7,11	0,89	500
EQ470	11,94	9,50	1,02	500
EQ490	12,45	17,45	1,19	500

FC

Flat caps 315 °C.



CODE	(mm)			PCS. BOX
	A	C	L	
FC70-1000	1,78	4,82	25,40	1000
FC100-1000	2,54	5,58	25,40	1000
FC100-1120	2,54	5,58	28,45	1000
FC120-400	3,05	6,09	10,16	1000
FC120-1000	3,05	6,09	25,40	1000
FC145-1120	3,68	6,72	28,45	1000
FC148-1000	3,76	6,80	25,40	1000
FC172-800	4,37	7,41	20,32	1000
FC175-1000	4,45	7,49	25,40	1000
FC185-1120	4,70	7,74	28,45	1000
FC220-1120	5,59	8,63	28,45	500
FC220-1650	5,59	8,63	41,91	500
FC223-1500	5,66	8,70	38,10	500
FC234-1500	5,94	8,98	38,10	500
FC295-250	7,49	10,53	6,35	500
FC295-1500	7,49	10,53	38,10	500
FC300-1120	7,62	10,66	28,45	500
FC300-1650	7,62	10,66	41,91	500
FC355-1500	9,02	12,06	38,10	500
FC375-1120	9,53	12,57	28,45	500
FC375-1500	9,53	12,57	38,10	500
FC393-728	9,98	13,02	18,49	500
FC415-1500	10,54	13,58	38,10	500
FC437-1000	11,10	14,14	25,40	500
FC440-728	11,18	14,22	18,49	500
FC456-1120	11,58	14,62	28,45	500
FC456-1500	11,58	14,62	38,10	500
FC480-1500	12,19	15,23	38,10	500
FC535-1500	13,59	16,63	38,10	250
FC562-1500	14,27	17,31	38,10	250
FC590-708	14,99	18,03	17,98	250
FC600-1500	15,24	18,28	38,10	250
FC640-900	16,26	19,30	22,86	250
FC640-2000	16,26	19,30	50,80	250
FC665-732	16,89	19,93	18,59	250
FC687-330	17,45	20,49	8,38	250
FC722-4555	18,34	21,38	115,70	250
FC728-452	18,49	21,53	11,48	250
FC730-1500	18,54	21,58	38,10	250
FC730-4000	18,54	21,58	101,60	250
FC736-728	18,69	21,73	18,49	250
FC811-728	20,60	23,64	18,49	250
FC855-1500	21,72	24,76	38,10	250
FC921-728	23,39	26,43	18,49	250
FC970-4000	24,64	27,68	101,60	250
FC980-1500	24,89	27,93	38,10	250
FC-1000-650	25,40	28,44	16,51	250
FC-1291-905	32,79	35,83	22,99	100
FC-1555-1102	39,50	42,54	27,99	50
FC-1649-1102	41,88	44,92	27,99	50
FC-1772-670	45,01	48,05	17,02	50
FC-1850-1102	46,99	50,03	27,99	50
FC-1957-1515	49,71	52,75	38,48	50
FC-2885-1000	73,28	76,32	25,40	50

SZC

Easy use caps 315 °C. Internal ring improve cap tightness and the flange in the head allows an easy handling.

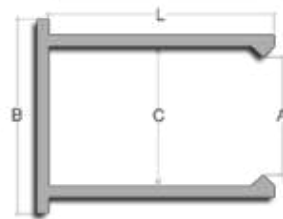

CODE	(mm)				PCS. BOX
	A	B	C	L	
SZC125-2000	3,18	16,51	6,35	50,80	500
SZC135-1180	3,43	16,76	6,60	29,97	500
SZC138-1180	3,51	16,84	6,68	29,97	500
SZC156-2000	3,96	17,30	7,14	50,80	500
SZC157-1180	3,99	17,32	7,16	29,97	500
SZC165-1016	4,19	17,53	7,37	25,81	500
SZC177-1180	4,50	17,83	7,67	29,97	500
SZC180-2000	4,57	17,91	7,75	50,80	500
SZC187-1377	4,75	18,08	7,92	34,98	500
SZC187-1747	4,75	18,08	7,92	44,37	500
SZC197-1180	5,00	15,80	9,40	37,00	250
SZC234-2000	5,94	19,28	9,12	50,80	250
SZC236-1180	5,99	19,33	9,17	29,97	250
SZC255-910	6,48	19,81	9,65	23,11	250
SZC125-2000	3,18	16,51	6,35	50,80	500
SZC135-1180	3,43	16,76	6,60	29,97	500
SZC138-1180	3,51	16,84	6,68	29,97	500
SZC156-2000	3,96	17,30	7,14	50,80	500
SZC157-1180	3,99	17,32	7,16	29,97	500
SZC165-1016	4,19	17,53	7,37	25,81	500
SZC177-1180	4,50	17,83	7,67	29,97	500
SZC180-2000	4,57	17,91	7,75	50,80	500
SZC187-1377	4,75	18,08	7,92	34,98	500
SZC187-1747	4,75	18,08	7,92	44,37	500
SZC197-1180	5,00	15,80	9,40	37,00	250
SZC234-2000	5,94	19,28	9,12	50,80	250
SZC236-1180	5,99	19,33	9,17	29,97	250
SZC255-910	6,48	19,81	9,65	23,11	250

CCC

Silicone Conecaps 315 °C. Recommended for powder coating, E-coating and plating.

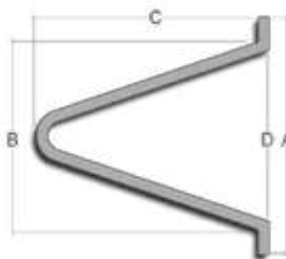

CODE	(mm)				PCS. BOX
	A	B	C	D	
CCC1	12,70	6,35	23,01	3,30	200
CCC2	12,70	8,03	25,40	5,49	200
CCC3	15,88	8,51	25,40	4,50	200
CCC4	16,51	10,01	27,99	5,00	200
CCC5	16,13	10,16	27,94	5,84	200
CCC6	19,05	14,00	35,99	8,00	200
CCC7	24,89	17,50	38,10	11,51	200
CCC8	27,94	19,48	51,03	13,51	100
CCC9	25,40	20,80	49,00	14,81	100
CCC10	30,99	22,00	53,01	16,00	100

CBI

Caps with rings 315 °C. Internal rings allow an easy handling on long pivots/threads with big diameters and increase cap tightness.



CODE	(mm)			PCS. BOX
	d	D	L	
CBI3-6	3,00	6,00	39,00	100
CBI6-9	6,00	9,00	39,00	100
CBI9-12	9,00	12,00	39,00	100
CBI12-15	12,00	15,00	39,00	100
CBI15-18	15,00	18,00	39,00	50
CBI18-21	18,00	21,00	39,00	50
CBI21-24	21,00	24,00	39,00	50
CBI24-27	24,00	27,00	39,00	50
CBI27-30	27,00	30,00	52,00	25
CBI30-33	30,00	33,00	52,00	25
CBI33-36	33,00	36,00	52,00	25
CBI36-39	36,00	39,00	52,00	25
CBI39-42	39,00	42,00	52,00	25
CBI42-45	42,00	45,00	52,00	10
CBI45-48	45,00	48,00	52,00	10
CBI48-51	48,00	51,00	52,00	10
CBI51-54	51,00	54,00	52,00	10

CF

Washer Caps 315 °C. Dual purpose plug. Ideal for masking around hole for earthing purpose.

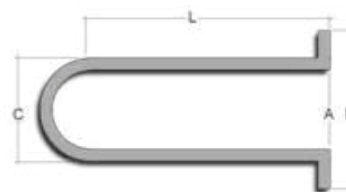
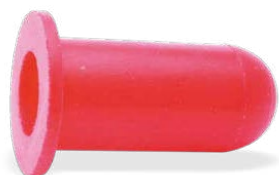

CODE	(mm)				PCS. BOX
	A	B	C	L	
CF100-500	2,54	12,70	5,72	25,40	500
CF125-500	3,18	12,70	6,40	25,40	500
CF140-500	3,56	12,70	8,20	25,40	500
CF156-500	3,96	12,70	8,00	25,40	500
CF172-500	4,37	12,70	9,70	25,40	500
CF180-600	4,57	15,24	8,00	25,40	250
CF220-500	5,59	14,99	9,09	25,40	250
CF220-787	5,59	19,99	8,71	25,40	250
CF295-500	7,49	12,70	10,49	25,40	250
CF295-700	7,49	17,78	10,49	25,40	250
CF295-1000	7,49	25,40	10,49	25,40	250
CF300-675	7,62	17,15	10,59	25,40	250
CF376-825	9,53	20,96	13,00	38,10	250
CF460-700	11,68	17,78	14,50	25,40	100
CF500-1000	12,70	25,40	15,39	25,40	100
CF616-1180	15,62	29,97	20,70	38,10	100
CF780-1475	19,81	37,47	24,69	25,40	100

CR

Caps with flange 315 °C. To mask holes and first thread.

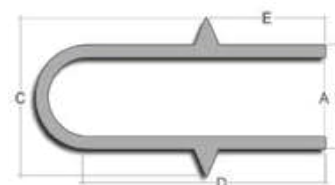

CODE	COLOR	(mm)					PCS. BOX
		A	B	C	D	E	
CR8	yellow	4,39	7,39	11,99	30,99	11,99	250
CR10	pink	5,69	8,71	13,00	32,00	14,71	250
CR12	clear	7,65	10,69	14,00	33,02	15,80	250
CR12L	clear	8,00	10,69	14,00	45,66	15,80	250
CR14	grey	10,69	13,69	15,01	34,04	18,01	250
CR14L	clear	9,55	12,70	17,02	57,15	17,53	250

Accessories

Hooks

Steel and iron hooks for painting and coating processes

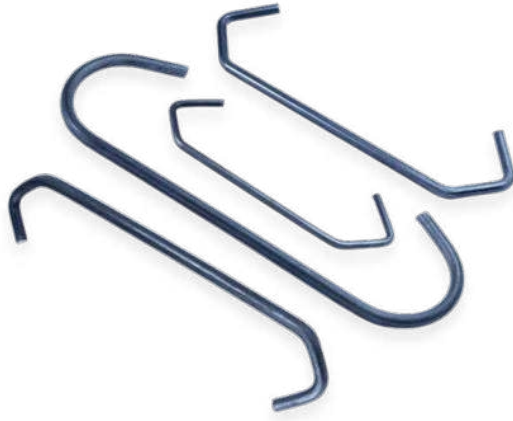

Model	Shape	Diameter		Length	
		in	mm	in	mm
C-044-3	C	0.044	1.1	3	76.2
CV-062-4	CV	0.062	1.6	4	101.6
CV-044-3	CV	0.044	1.1	3	76.2
C-062-4	C	0.062	1.6	4	101.6
C-076-6	C	0.076	1.9	6	152.4
V-076-4	V	0.076	1.9	4	101.6
S-076-4	S	0.076	1.9	4	101.6
V-180-12	V	0.18	4.6	12	304.8
V-193-7	V	0.193	4.9	7	177.8



| **XMA**

Cd Juarez, Chihuahua
C Ramon Rayon 1520-7
Col Manuel Valdez
32650 Cd Juarez, Chihuahua
+52 656 887 3756

El Paso, Texas
10420 Montwood Dr
37995 El Paso, Texas
+1 915 301 0400

ventas@xma.mx
www.xma.mx